



SYMKLOUD-MS

OneClick Bundle 3.18.00

Release Notes

PCN no.: 2112

Revision	Brief Description of Changes	Date of Issue
0.1	Initial release	14-Sept-2021

1/ Description of the change(s)

The new OneClick bundle Quartz Elfin (version 3.18.00) is now available for the SYMKLOUD-MS platform, which includes all new firmwares for the listed Symkloud series systems.

1.1. OneClick bundle 3.18.00

The versions of each firmware component included in the bundle are listed in the table below, with those that have been updated (vs. the versions included in the previous bundle) highlighted in **bold**. The changes introduced in each individual firmware component are listed in section "4/ Individual Changelog" of this document.

	Product	Component	Previous version	New version
	OneClick Bundle MS29XX		3.17.00(Peanut Elfin)	3.18.00(Quartz Elfin)
Hub Nodes	MSH8900	ShMC	3.23.0950DCB8	3.24.09564C66
		FPGA	2.06	same
	MSH8910	ShMC	2.25.0950DCB9	2.26.09564C66
		FPGA	1.12	same
	MSH8920	ShMC	1.22.0148847a	1.23.01564bf2
		FPGA	1.05.0800D656	same
Compute Nodes	MSP800x	BIOS	1.00	same
		IPMC	3.33.0916B3EC	same
		FPGA	1.10	same
	MSP802x	BIOS	2.21.093A2A53	same
		IPMC	2.20.091805DF	same
		FPGA	2.14	same
	MSP803x	BIOS	2.16	same
		IPMC	1.01.090A145F	same
		FPGA	1.00	same
	MSP804x	BIOS	1.58.094AF3D8	1.61.09537B54
		IPMC	1.20.0950DCB9	2.03.09564C9A
		FPGA	2.02	same
	MSP805x	BIOS	1.07.093A4DC4	same
		IPMC	1.11.09510C90	1.12.09564C66
		FPGA	1.02	same
	MSP806x	BIOS	1.14.094AF3E9	same
		IPMC	1.15.015123fa	1.16.01564bf1
		FPGA	1.01.0800f920	same

2/ Change Classification

Classification	○ Maintenance release, Product improvement
Application	○ The Firmware is field upgradeable

3/ Impact on customer application and recommended actions

In order to benefit from the latest features, enhancements and fixes, Kontron recommends that customers upgrade all SYMKLOUD-MS systems and components to the latest firmware versions as soon as is practical.

4/ Individual Changelogs

Product	Component & Version	Changelog
MSH8900	ShMC 3.24.09564C66	<p>Changes since 3.23.0950DCB8</p> <p>Bug fixes:</p> <ul style="list-style-type: none"> Fixed an issue where ipmitool command Fru print would not display all FRUs Fixed a buffer overflow vulnerability <p>Internal Improvements:</p> <ul style="list-style-type: none"> SMcore binary updated BMC prompt updated to include MSP8070

Product	Component & Version	Changelog
MSH8910	ShMC 2.26.09564C66	<p>Changes since 2.25.0950DCB9</p> <p>Bug fixes:</p> <ul style="list-style-type: none"> Fixed an issue where ipmitool command Fru print would not display all FRUs Fixed a buffer overflow vulnerability <p>Internal Improvements:</p> <ul style="list-style-type: none"> SMcore binary updated BMC prompt updated to include MSP8070

Product	Component & version	Changelog
MSH8920	ShMC 1.23.01564bf2	<p>Changes since 1.22.0148847a</p> <p>Bug fixes:</p> <ul style="list-style-type: none"> Fixed an issue where ipmitool command Fru print would not display all FRUs Fixed a buffer overflow vulnerability Fixed an issue where false positives of overvoltage were generated in the SEL <p>Internal Improvements:</p> <ul style="list-style-type: none"> SMcore binary updated BMC prompt updated to include MSP8070 Added timestamps to systemInformation.txt Increased scrollbackdepth from 500 to 4k lines in Shell-in-a-box

Product	Component & Version	Changelog
MSP8040 MSP8070	BMC 2.03.09564C9A	Changes since IPMC version 1.20.0950DCB9 Bug Fix <ul style="list-style-type: none"> Fixed a buffer overflow vulnerability Fixed an issue where false temperature thresholds alarms were generated
	BIOS 1.61.09537B54	Changes since BIOS version 1.58.094AF3D8 <ul style="list-style-type: none"> Increased BIOS version Added SG1 PCIe support for MSP8070

Product	Component & Version	Changelog
MSP8050	BMC 1.11.09510C90	Changes since IPMC version 1.11.09510C90 Bug Fixes: <ul style="list-style-type: none"> Fixed a buffer overflow vulnerability Fixed an issue where ipmitool command Fru print would not display all FRUs Disabled a feature prone to web vulnerability

Product	Component & Version	Changelog
MSP8060	BMC 1.15.015123fa	Changes since 1.15.015123fa Bug fixes: <ul style="list-style-type: none"> Fixed an issue where ipmitool command Fru print would not display all FRUs Fixed a buffer overflow vulnerability Fixed an issue where false positives of overvoltage were generated in the SEL

5/ Associated Network OS

5.1. : Release History

Firmware Package Version	Release Date	Chassis Support	MSH8900	MSH8910	MSH8920
3.18.00	Sept-2021	MS29xx, MS1300	2.26	HOTFIX4.51	1.7.2-12
3.17.00	Mar-2021	MS29xx, MS1300	2.25	HOTFIX4.51	1.7.2-12
3.16.00	Nov-2020	MS29xx, MS1300	2.25	HOTFIX4.51	1.7.2-12
3.15.00	Aug-2020	MS29xx, MS1300	2.25	HOTFIX4.51	1.7.2-12
3.14.00	Apr-2020	MS29xx, MS1300	2.24	HOTFIX4.51	1.7.2-12
3.13.00	Dec-2019	MS29xx, MS1300	2.23	HOTFIX4.51	1.7.2-12
3.12.00	Sept-2019	MS29xx, MS1300	2.23	HOTFIX4.51	1.7.2-12
3.11.00	Feb-2019	MS29xx, MS1300	2.22	GA4.50	1.7.2-12
3.10.00	Feb-2019	MS29xx, MS1300	2.22	GA4.50	1.7.2-12
3.09.01	Jan-2019	MS29xx	1.14	GA4.50	1.6.4-24
3.08.00	Oct-2018	MS29xx	1.14	GA4.50	1.6.4-24
3.07.00	Apr-2018	MS29xx	1.14	GA4.50	1.6.4-24
3.06.02	Feb-2018	MS29xx	1.14	GA4.50	1.6.4-24
3.05.01	Dec-2017	MS29xx	1.12	HOTFIX4.00	1.5.4-32
3.04.05	Apr-2017	MS29xx	1.12	HOTFIX4.00	N/A
3.00	May-2016	MS29xx	1.12	HOTFIX3.02	N/A
2.16	Sept-2015	MS29xx	1.12	GA2.01	N/A

6/ How to identify your product

MSH-Hub Nodes and MSP-Nodes

Electronically:

- From the System Monitor WebUI/API (including SystemInformation.txt)
- From any specific component's ipmitool interface (IoL, Serial, etc.) with the command 'hpm check'

Physical labels:

- Each MSH-Hub Nodes and MSP-Nodes includes a 2D barcode on its faceplate, encoding the following details:

Board serial number 90xxxxxxxx
 Board part number xxxx-xxxx
 Batch ID xxyyzzzzzz
 Base MAC address 00:A0:A5:xx:xx:xx

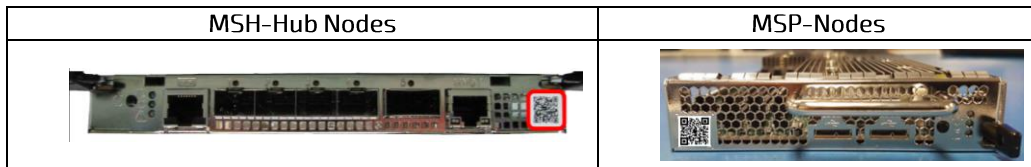

MS29xx Chassis

Electronically:

- From the Active ShMC's ipmitool interface (IoL, serial, etc.) with the command 'fru print'; the Chassis SN/PN is listed under FRU Device Description : "PDB 1 (ID 128)" and "PDB 2 (ID 130)"

Physical labels:

- Located on the top-cover of the system, the serial number and Batch ID labels encode:

Board serial number 90xxxxxxxx
 Board part number xxxx-xxxx
 Batch ID xxyyzzzzzz

The System serial number is also encoded on the front-faceplate 'Symkloud' Label (shown below).

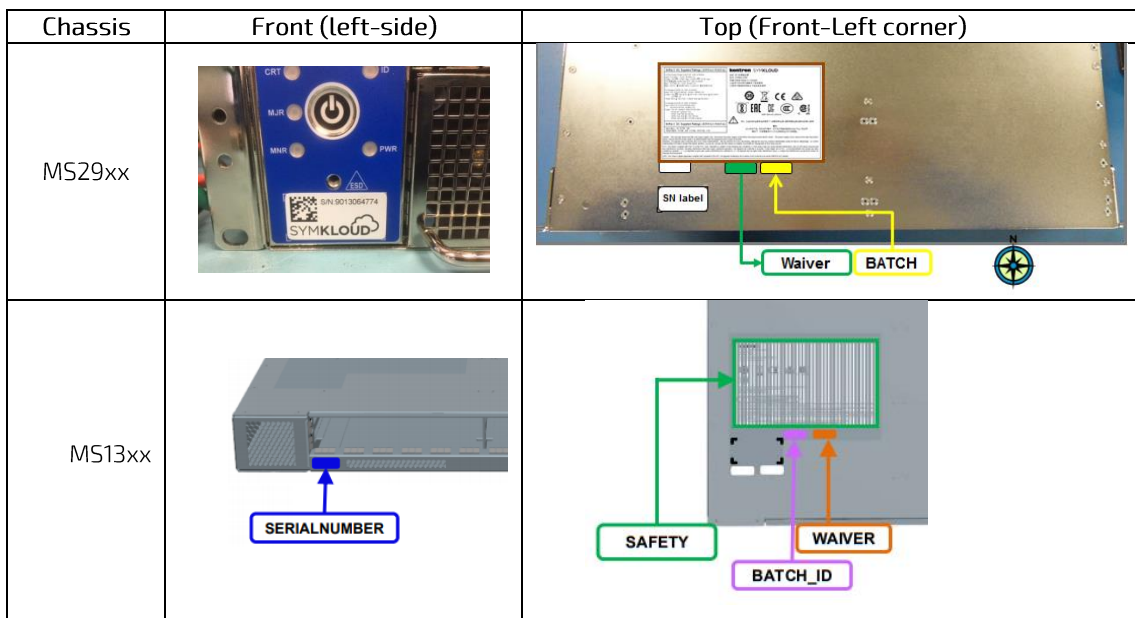

About Kontron in Communications

Kontron designs hardware for the software-defined world. Service providers and enterprise clients around the globe collaborate with Kontron and its ISV and channel partners to deploy new services with greater speed, confidence and operational efficiency. Our portfolio is a best-of-breed of OEM hardware and SYMKLOUD Open Infrastructure Platforms dedicated to the deployment of virtual services using software defined networks (SDN) and network functions virtualization (NFV). For more information, please visit www.symkloud.com or www.kontron.com/communications.

CORPORATE OFFICES

KONTRON CANADA

4555 Ambroise-Lafortune
Boisbriand, QC
Canada J7H 0A4
Tel.: +1 450 437-5682
Tel.: +1 800 387-4223